



*jordan fishwick*

**DIDSBURY**  
Parrs Wood Court



## Parrs Wood Court, Didsbury, M20 5NG

£160,000



### The Property

A STYLISH TOP FLOOR APARTMENT forming part of the popular Parrs Wood Court, which is a gated development with a most convenient location in Didsbury, with easy access to the train station, Metrolink, bus routes and motorway network. Located on the TOP FLOOR with ELEVATED VIEWS, the living space is presented to a high standard throughout and boasts numerous noteworthy features to include an entrance hall, lounge/dining room extending over 21ft, modern fitted kitchen, double bedroom with fitted wardrobes and a recently fitted contemporary shower room. In addition, there is uPVC double glazing throughout, electric heating, lift access to all floors and secure gated parking.

### Directions

M20 5NG

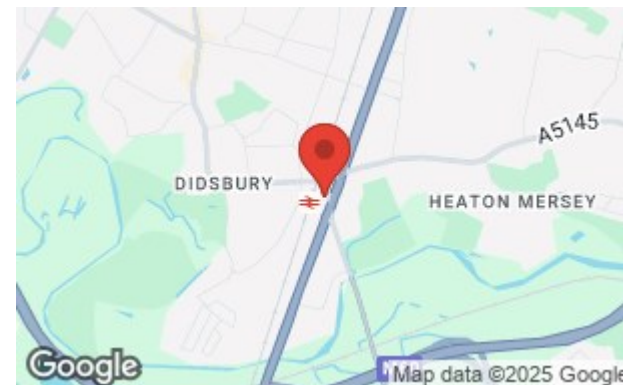

- Stylish top floor apartment
- Convenient location
- Elevated views
- Lounge/dining room over 21ft
- Fitted kitchen
- Contemporary shower room
- Double glazed
- Electric heating
- Gated parking
- Use of communal roof terrace

Postcode - M20 5NG

EPC Rating - E

Floor Area - 493.00 sq ft

Local Authority - Manchester City Council

Council Tax - A



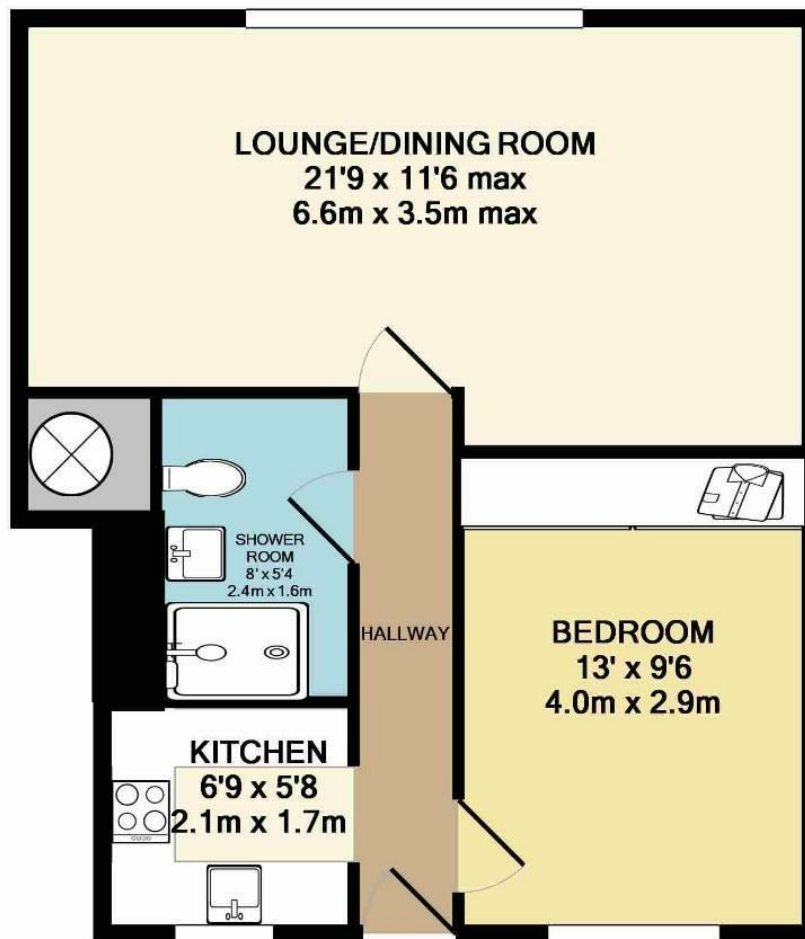

TOTAL APPROX. FLOOR AREA 493 SQ.FT. (45.8 SQ.M.)  
 Measurements are approximate. Not to scale. Illustrative purposes only  
 Made with Metropix ©2018



These particulars are believed to be accurate but they are not guaranteed and do not form a contract. Neither Jordan Fishwick nor the vendor or lessor accept any responsibility in respect of these particulars, which are not intended to be statements or representations of fact and any intending purchaser or lessee must satisfy himself by inspection or otherwise as to the correctness of each of the statements contained in these particulars. Any floorplans on this brochure are for illustrative purposes only and are not necessarily to scale.

Offices also at: Wilmslow, Macclesfield, Hale, Sale, Chorlton, Glossop, Manchester & Salford

757-759 Wilmslow Road, Didsbury Village, Manchester

0161 445 4480

didsbury@jordanfishwick.co.uk  
 www.jordanfishwick.co.uk